



**CALL FOR ARTISTS**  
**TEMPORARY OUTDOOR PUBLIC ART INSTALLATION**  
**FOREST at LAGUNA**

Nestled along the stunning Southern California coastline, Laguna Beach is renowned for its vibrant arts community, breathtaking natural beauty, and deep cultural heritage. With a population of approximately 23,000, the city is a haven for creativity and a magnet for artists and art lovers worldwide.

Laguna Beach as a community has evolved with artists at its core, from Impressionist Painter Anna Hills being instrumental in forming our local government, to artists creating the Festival of Arts in response to the Depression. Today artists are still integral and involved with shaping the city and are a key driver of its economic engine.

Temporary public art installations grant artists the opportunity to reimagine a space in our community while also allowing those of us in the community to momentarily see ourselves from a different perspective. We invite artists to share their works temporarily with residents and visitors to Laguna Beach. Installations may last from two weeks to one year, typically remaining on view for three months. Project proposals are encouraged to explore artistic excellence that goes beyond technical proficiency, that involves pushing boundaries, challenging conventions and produces work that resonates with audiences on intellectual, emotional, and aesthetic levels with a strong creative vision.

The Mission of the City of Laguna Beach's Arts Commission and Cultural Arts Department is to bring public art that challenges, inspires and engages our residents and visitors in ways that enriches the quality of life. We recognize and celebrate art as a catalyst for creativity, conversation, connection, collaboration, and community. We support artists, elevate arts organizations, and foster appreciation for the central importance of the arts to a dynamic, innovative and economically thriving city.

We value the unique character of Laguna Beach, including its history, natural beauty, and the community's deep connection to the arts. While the City's public art is respectful of these elements, the primary goal of the art sought for FOREST at LAGUNA is to create iconic imagery, unique to the setting and scale of the location that enhances the Laguna Beach experience and that moves us forward toward a new language of art making.

We understand that not all will appreciate every type of public art exhibited in the City, but might appreciate the vibe, the people, or the artist. We know that public art becomes a talking point, a meeting place, a revelation, a celebration and it is through the diversity of this art that we find the vital conversations that are the blood of an artist's community. Art is exactly what we need right now.

Through the imagination and creativity of local, national, and international artists we share a journey from which we all collectively benefit. As we invite artists to share their works, we exemplify our core values to the highest degree: As welcoming and engaged residents.

Laguna Beach has been a historic art colony since the early 20th century and continues to celebrate the arts through iconic festivals such as the *Pageant of the Masters*, *Festival of Arts*, *Sawdust Art Festival*, *Art-A-Fair*, and *Coast Film Festival*. Public art plays a central role in the city's identity, with over 100 installations enriching the landscape and fostering dialogue between residents and visitors. Other significant art organizations include the Laguna Playhouse, the Laguna College of Art and Design and the Laguna Beach Art Museum.

In addition to its arts legacy, Laguna Beach offers a picturesque setting of sandy beaches, rocky coves, and dramatic coastal bluffs. The city's commitment to environmental stewardship and sustainable practices further enhances its appeal as a forward-thinking and culturally rich destination.

Artists chosen for public art projects in Laguna Beach will have the unique opportunity to contribute to the city's dynamic cultural fabric and engage with a community that values artistic expression, innovation, and the celebration of natural beauty.

### **OVERVIEW: FOREST AT LAGUNA**

The Forest at Laguna will be a new permanent pedestrian plaza in Downtown Laguna Beach providing a mix of uses including outdoor dining, shopping, live music and community gathering. It will serve as a multifaceted living room for Laguna Beach, a central gathering place for residents and visitors alike. There will be a stage for music and seasonal events and an immersive setting for strolling and savoring the majesty of the sun setting over the Pacific. FOREST at LAGUNA will include a series of pedestrian oriented temporary art installations to activate the street, bring additional vibrancy and spark conversation, and add diversity to the City's permanent public art collection. The goal is to continually reinvent the space with new art experiences.

### **OPPORTUNITY:**

The Arts Commission is inviting artists to submit proposals for temporary art works for display at FOREST at LAGUNA. Works may be suspended or installed in various areas throughout the Plaza. Works will be selected by the City of Laguna Beach Arts Commission and on loan from the artist for a specified period. Installations must be durable and safe to the public and environment and withstand an unprotected display in a downtown plaza setting. The rotating temporary works must be appropriate in content for a public setting and audiences of all ages, while offering innovative and unique vision that will help to define FOREST at LAGUNA as a creative community gathering place to be savored and shared, time after time.

**SUBMISSION DATE:** Open through March 2, 2026.

**EXHIBITION TIMELINE:** From sixty days up to but not to exceed one year

**ELIGIBILITY:** Open to artist(s) or artist team with demonstrated experience in designing, creating, and installing pedestrian orientated site-responsive public art.

**BUDGET:** A rental honorarium is evaluated on the proposal to include installation, deinstallation, liability insurance and rental cost. Works remain the property of the artist.

The selected artist(s) or artist team will be required to enter a contract with the City of Laguna Beach and have liability insurance naming the City as additionally insured for installation and removal.

**APPLICATIONS:** Should include the following:

- Professional Resume (one page): include relevant public art experience.
- Material Description
- Installation method
- Renderings of the proposed artwork
- Proposed placement
- Proposed duration and exhibition period
- Artist Statement (maximum 500 words): describe your artistic vision and approach to the pedestrian orientated public art being proposed.
- Images of previous work. Include images/works that are relevant to the proposed project.
- References: Contact information for three professional references familiar with your work.

## SELECTION PROCESS:

The Arts Commission will review the applications and make their selection based on the following:

- **Qualifications:** Artist qualifications as demonstrated by past work and the appropriateness of their concepts to the project. Of highest priority are the artistic capabilities of the artist and the inherent quality of their original artwork to enhance the City's cultural profile.
- **Artistic Excellence:** Artists and the proposal shall demonstrate excellence of creative and aesthetic ideas, a mastery of skills and techniques in the creation of original art works, communication of unique vision or perspective, and professional approaches to process and presentation. The Arts Commission will apply aesthetic and artistic judgements in their review, including those noted within this proposal narrative.
- **Appropriateness to Site:** Artwork shall be appropriate in scale, material, form, and content for the site.
- **Durability:** Highly durable and safe artwork designed to withstand the natural elements and public space.
- **Public Liability:** Safety conditions or factors that may bear on public liability.
- **Diversity:** Diversity of style, scale, media, and artists.
- **Content:** Appropriateness and relevance and should not contradict the City's values of environmental sustainability, accessibility, and cultural inclusiveness.

The Arts Commission may select one or multiple proposals and reserves the right to reject all proposals.

A proposal for a temporary installation is first reviewed by the Arts Commissions Public Art Sub-Committee. If the proposal is approved by the subcommittee the item will be placed on the agenda for the full Arts Commission. The Arts Commission meets on the second and fourth Monday of the month in the City Council Chambers located at 505 Forest Avenue, Laguna Beach, CA.

Applications must be submitted online at <https://lagunabeachcity.slideroom.com/> by March 2, 2026.

Click [HERE](#) for further Cultural Arts Information.

This program has been funded by the lodging establishments and City of Laguna Beach.



CALL FOR ARTISTS  
TEMPORARY OUTDOOR PUBLIC ART INSTALLATION  
Site Specifications

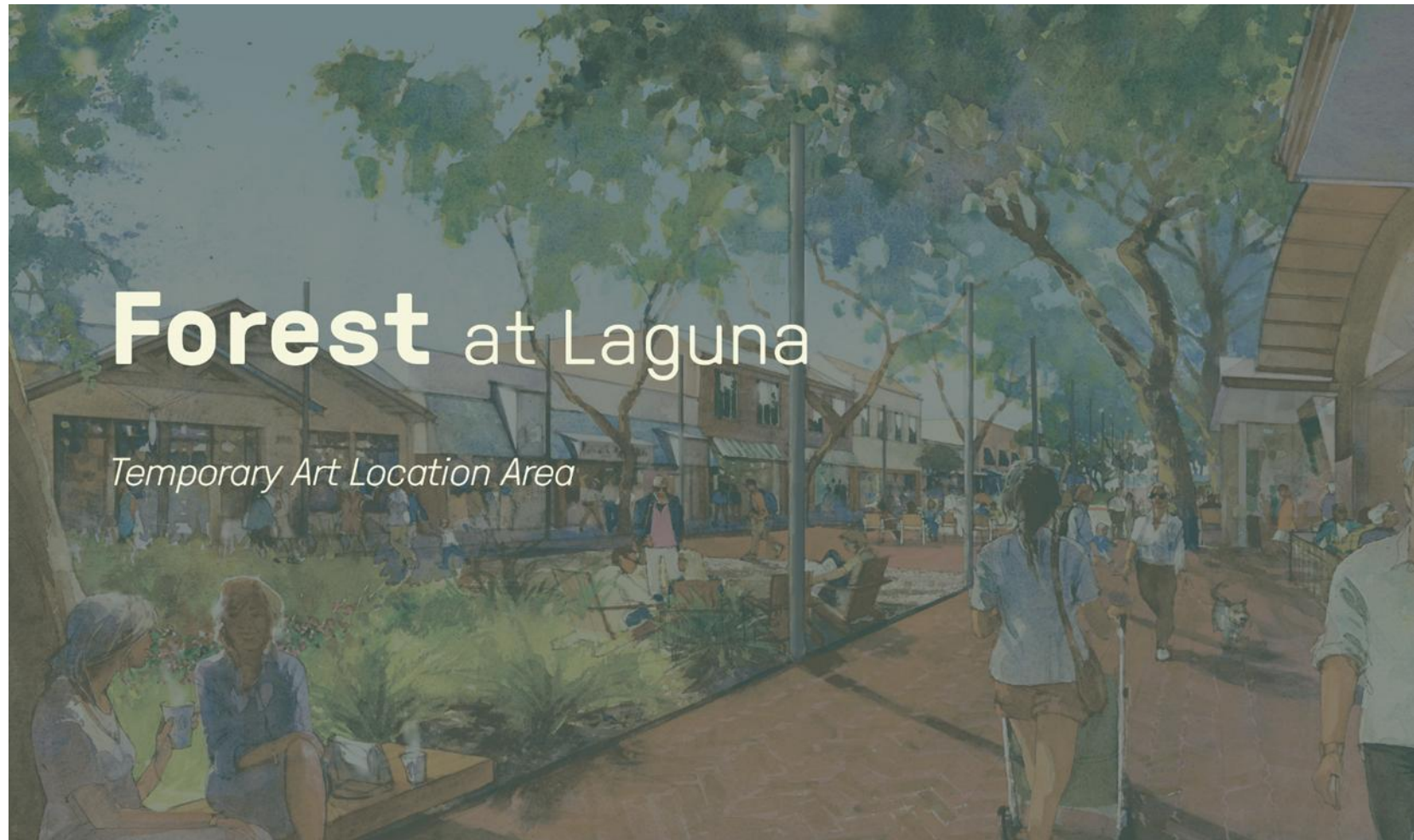





# Forest Public Art Location

## Ground Level

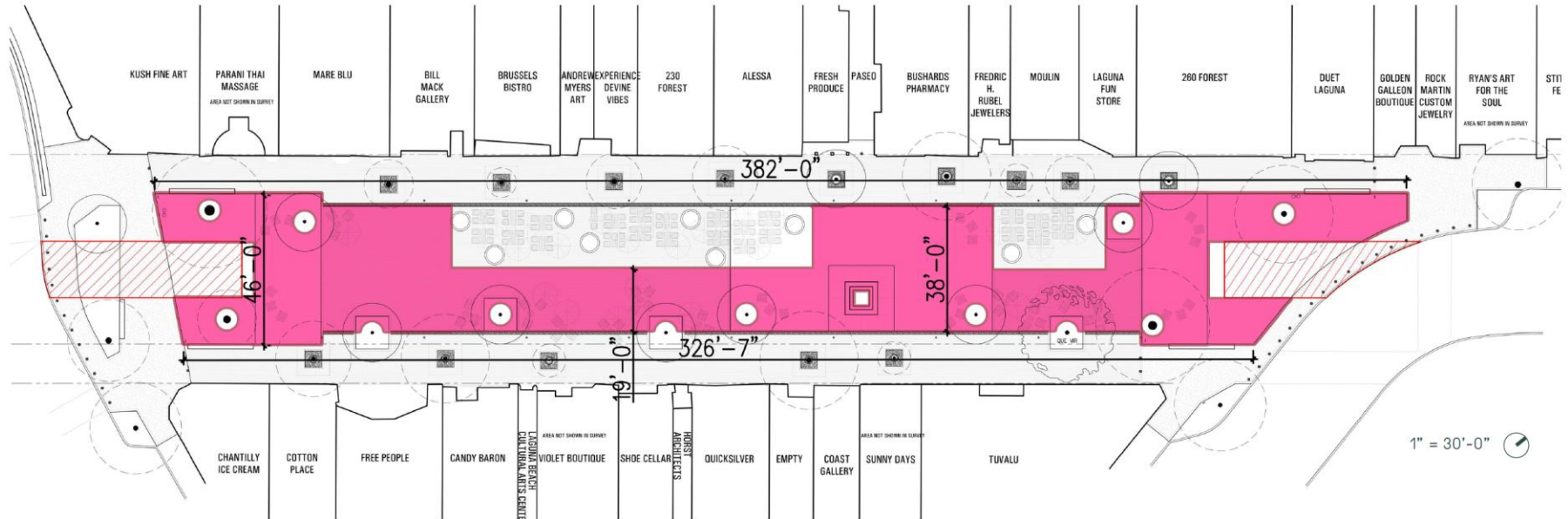

### Area

Within highlighted area.

### Requirements

- Art pieces must be 5' clear of tree trunks.
- Cannot disturb any ground planting.
- Cannot attach from trees.
- Must avoid damaging brick paving or disturbing decomposed granite paving.
- Cannot penetrate below ground level or into paving.

# Forest Public Art Location

## Overhead Level

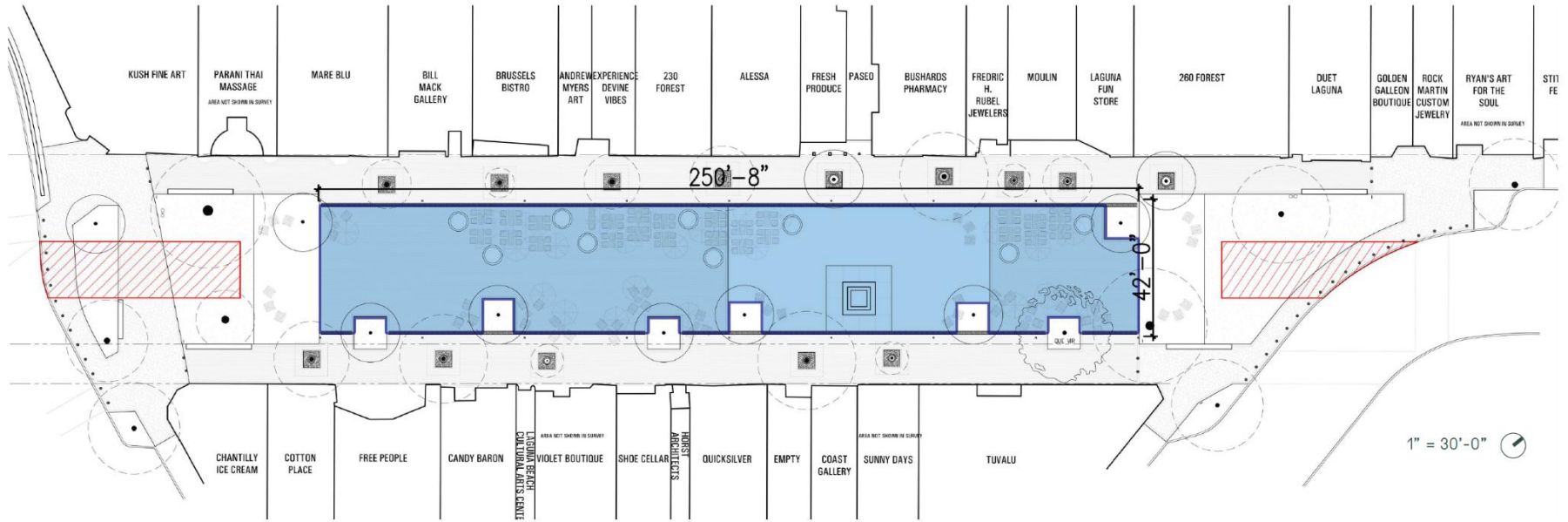

### Area

Within highlighted area.

### Requirements

- Hanging art must be a minimum 10' above the ground.
- Maximum height of hanging art is 42" (Starting height is 13.5' above the ground)
- Attach to steel cable.
- Cable spacing TBD.
- Cable weight limit TBD.

### Height Zone

